

# ABBATRON

Premier Supplier of Electronic Hardware

HH Smith

Custom Capabilities Test Accessories Plugs, Jacks, Posts Connectors Hardware Spacers/Standoffs

- [Home](#)
- [About](#)
- [Abbatron](#)
- [Products](#)
- [Locate](#)
- [Distributor](#)
- [or](#)
- [Representative](#)
- [Contact Us](#)
- [Request](#)
- [Information](#)
- [Site Map](#)

## Brass Hex Standoffs

- Standard Nickel Plating provides a hard, bright, non-oxidizing surface which will stand up to difficult ambient conditions

Options include:

- Alternative plating finishes, odd sizes, taps, or threads
- Metric spacers are also available by custom order from the factory. Call for more information

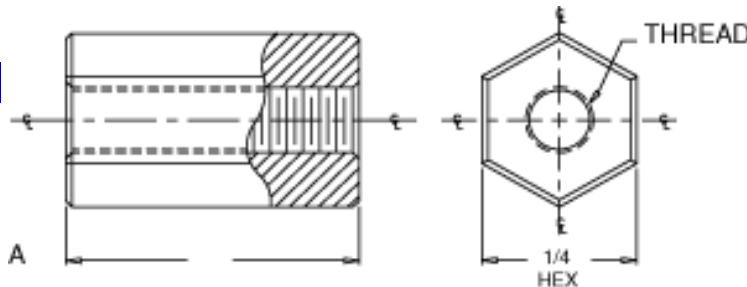
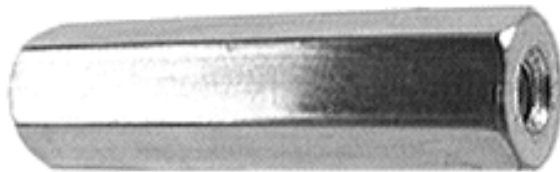

Inventory Search

Cross Reference

UPS Tracking

LENGTH		HEX	THREAD				
			#2-56	#4-40	#6-32	#8-32	#10-32
.125	1/8	3/16	9130	9145			
		1/4		8820	8821	8822	
		5/16			9382A	9383A	9384A
		3/8				7952	9385A
.187	3/16	3/16	9131	9146			
		1/4		8823	8824	8825	
		5/16			9382B	9383B	9384B
		3/8				7955	9385B
.250	1/4	3/16	9132	9147			
		1/4		2330	2320	2325	
		5/16			9382C	9383C	9384C
		3/8				7958	9385C
.312	5/16	3/16	9133	9148			
		1/4		8826	8827	8828	
		5/16			9382D	9383D	9384D
		3/8				7961	9385D
.375	3/8	3/16	9134	9149			
		1/4		2331	2321	2326	
		5/16			9382E	9383E	9384E
		3/8				7964	9385E
.437	7/16	3/16	9135	9150			
		1/4		8829	8830	8831	
		5/16			9382F	9383F	9384F

632 Arch Street, POB  
726 Meadville, PA 16335  
USA 814-724-6440

[Contact Webmaster](#)

© June 6, 2005

		5/16			9382E	9383E	9384E
		3/8			7964	9385E	
.437	7/16	3/16	9135	9150			
		1/4		8829	8830	8831	
		5/16			9382F	9383F	9384F
		3/8			7967	9385F	
.500	1/2	3/16	9136	9151			
		1/4		2332	2322	2327	
		5/16			9382G	9383G	9384G
		3/8			7970	9385G	
.562	9/16	3/16	9137	9152			
		1/4		8832	8833	8834	
		5/16			9382H	9383H	9384H
		3/8			7973	9385H	
.625	5/8	3/16	9138	9153			
		1/4		8835	8836	8837	
		5/16			9382J	9383J	9384J
		3/8			7976	9385J	
.687	11/16	3/16	9139	9154			
		1/4		8838	8839	8840	
		5/16			9382K	9383K	9384K
		3/8			7979	9385K	
.750	3/4	3/16	9140	9155			
		1/4		2333	2323	2328	
		5/16			9382L	9383L	9384L
		3/8			7982	9385L	
.812	13/16	3/16	9141	9156			
		1/4		8841	8842	8843	
		5/16			9382M	9383M	9384M
		3/8			7985	9385M	
.875	7/8	3/16	9142	9157			
		1/4		8844	8845	8846	
		5/16			9382N	9383N	9384N
		3/8			7988	9385N	
.937	15/16	3/16	9143	9158			
		1/4		8847	8848	8849	
		5/16			9382P	9383P	9384P
		3/8			7991	9385P	
1.00	1	3/16	9144	9159			
		1/4		2334	2324	2329	
		5/16			9382Q	9383Q	9384Q
		3/8			7994	9385Q	
1.125	1-1/8	1/4		8820R	8821R	8822R	
1.250	1-1/4			8820S	8821S	8822S	
1.375	1-3/8			8820T	8821T	8822T	
1.500	1-1/2			8820U	8821U	8822U	
1.625	1-5/8			8820V	8821V	8822V	
1.750	1-3/4			8820W	8821W	8822W	
1.875	1-7/8			8820X	8821X	8822X	
2.000	2			8820Y	8821Y	8822Y	

Maximum Thread Depth in Inches					
Thread Size	2 - 56	4 - 40	6 - 32	8 - 32	10 - 32
Thread Length Tapped Thru	5/8	1	1	1	1
Thread Length Tap each end	1/4	3/8	3/8	3/8	3/8